

BARGRAPH INDICATOR	model 48SV
---------------------------	-------------------

Thank you for choosing us. Before use, check specifications on the unit label.
 If you have any problems or questions with the product, please contact our sales office or representatives.

General Description

The Bargraph Indicator Model 48SV displays one process variable signal, in graphic indication of 51 LED segments.

Installation [Scale: mm(inch)]

- Operating temperature: 0 to 50°C (32 to 122°F)
 - Operating humidity: 40 to 80% RH. (non-condensing)
- Protect the unit from water, corrosive gas, dust and vibration.

■ **PANEL CUTOUT** Panel thickness: 0.5 to 2.0 mm (.02" to .08")

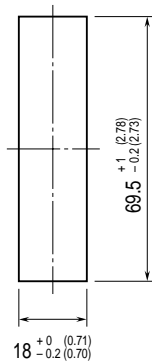

Terminal Connections

Make wiring to terminals as shown in the figure below.

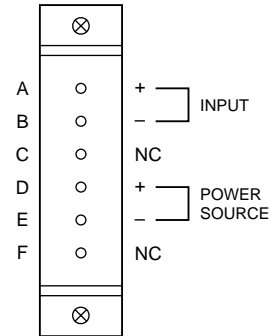

Troubleshooting

- When output is irregular, check the following points:
- A) Terminal wiring
 - B) Power: Check voltage across the terminal D – E with a voltmeter.
 - C) Check input signal level.