

## Bargraph Indicators *48 Series*

### BARGRAPH INDICATOR

MODEL **48SV**

#### MODEL & SUFFIX CODE SELECTION

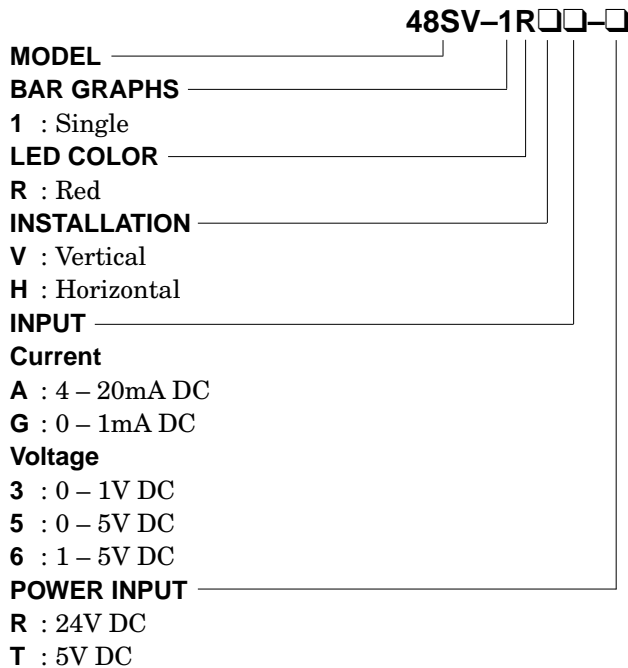

#### ORDERING INFORMATION

Specify code number. (e.g. 48SV-1RVA-T)

#### GENERAL SPECIFICATIONS

**Construction:** panel flush mounting

**Connection:** connector (leadwires soldered)

**Material**

**Housing:** ABS resin

**Scale plate:** aluminium (white scale & characters on black base)

**Scale:** 0 – 100%

**Indicator:** LED

**No. of LED segments:** 52 including over-range indicator "1"

**Scale length:** 50 mm (1.97")

**Isolation:** input to power

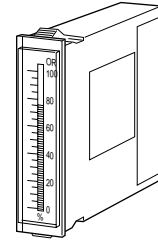

#### Functions & Features

- Displaying a process variable in graphic bargraph of 51 LED segments
- Small size
- High-density mounting

#### INPUT & OUTPUT

##### INPUT

• **DC Current:** 4 – 20mA DC, 0 – 1mA DC

##### Input resistance

Input	Input Resistance
4 – 20mA	: 5.1 (Ω)
0 – 1mA	: 100

• **DC Voltage:** 0 – 1V DC, 0 – 5V DC or 1 – 5V DC

##### Input resistance

Input Span	Input Resistance
0 – 1V	: 200k (Ω)
0 – 5V	: 160k
1 – 5V	: 160k

#### INSTALLATION

**Power input:** operational voltage range: 24V DC ±15% or 5V DC ±10%, 1.5W max.; ripple 10% p-p max.

**Operating temperature:** 0 to 50°C (32 to 122°F)

**Operating humidity:** 40 to 80% RH (non-condensing)

**Mounting:** panel flush mounting

**Dimensions:** W18×H72×D118 mm (0.71"×2.83"×4.65")

**Weight:** 90 g (0.20 lbs)

#### PERFORMANCE in percentage of span

**Accuracy:** ±2%

**Response time:** 0.5 seconds

**Insulation resistance:** ≥50MΩ with 500V DC (input or power to ground)

**Dielectric strength:** 2000V AC @1 minute (input or power to ground)

500V AC @1 minute (input to power)

**TERMINAL CONNECTION**

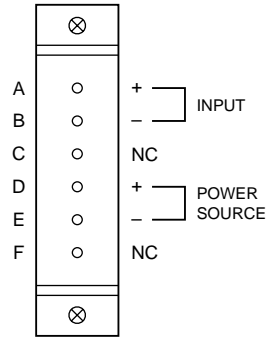

**MOUNTING REQUIREMENTS mm (inch)**

■ **PANEL CUTOUT**

Panel thickness: 0.5 – 2.0 mm (.02" – .08")

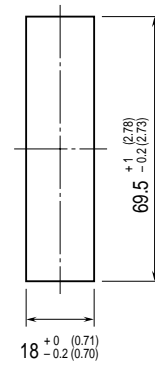

**EXTERNAL DIMENSIONS mm (inch)**

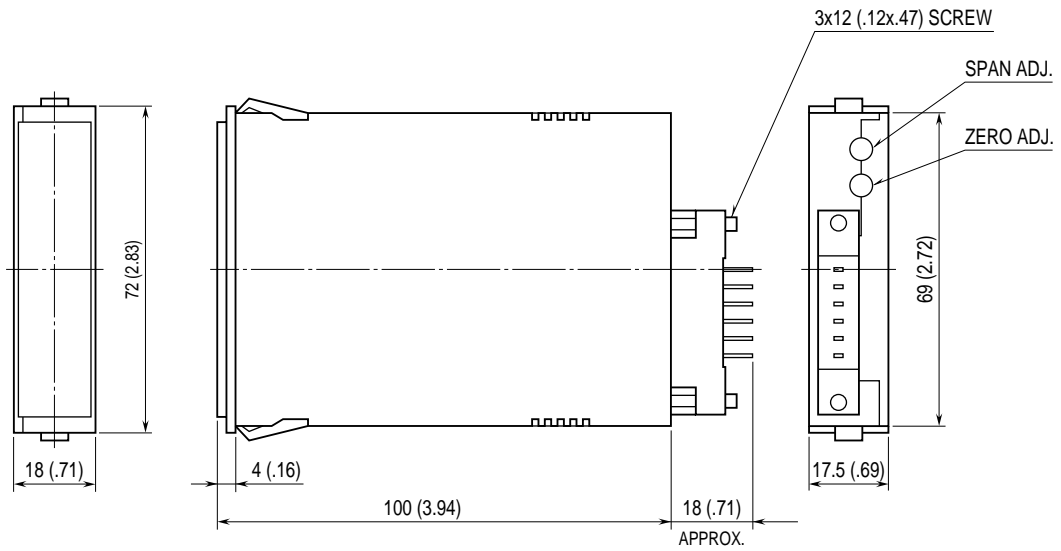

Specifications subject to change without notice.